

# ACER0730S "CARRARA" Lavabo in marmo bianco di Carrara / Washbasin in white Carrara marble

## DATI TECNICI / TECHNICAL DATA

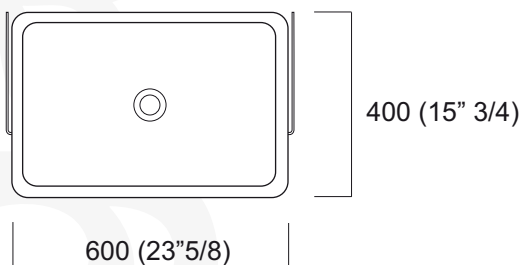

n°4  
vite Agape  
screw

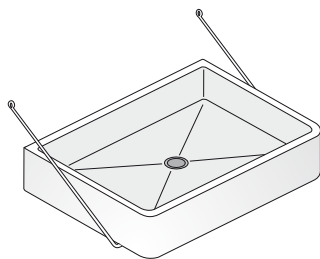
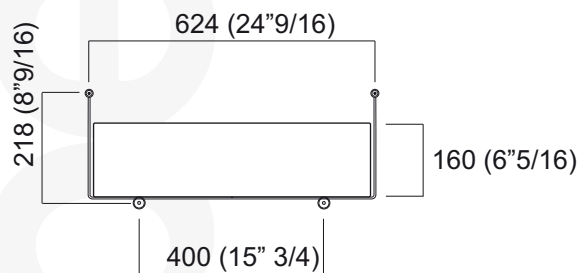

n°4  
Tassello ø 8 (5/16")  
plug



n°2  
TCTE M5x10  
screw



n°2  
supporti  
support

## STRUMENTI / TOOLS

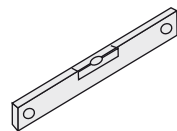
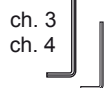

silicone trasparente antimuffa  
transparent antimould silicon

## SCHEMA ATTACCHI / DIAGRAM FOR WATER CONNECTIONS

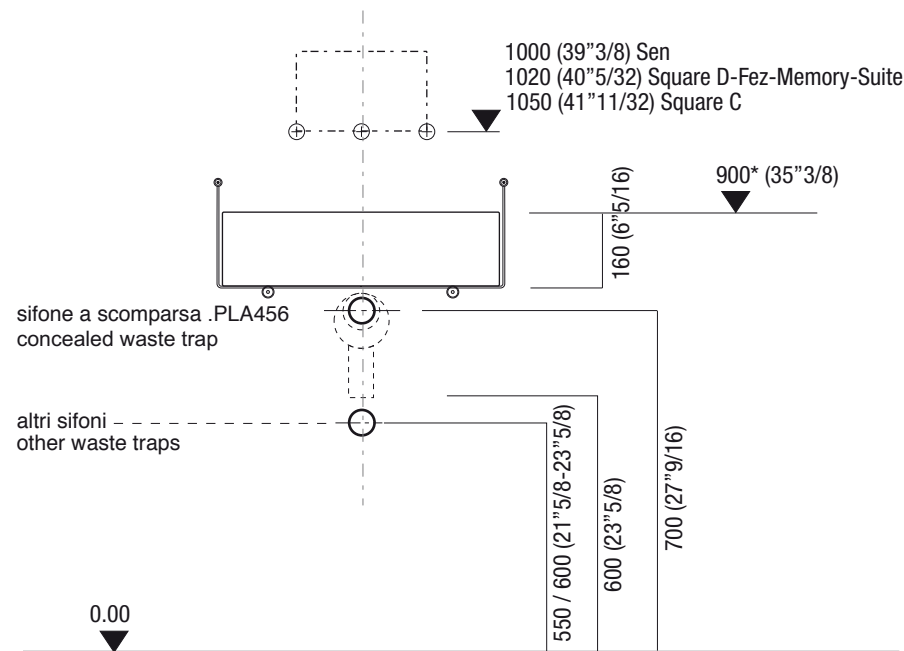

\*h.consigliata / advised h.

Assicurarsi che la parete sia portante; in caso di parete in mattoni forati adottare altri fissaggi specifici. Si sconsiglia il fissaggio su pareti di cartongesso.

Verify that the wall is load-bearing. In case of a hollow block wall, do not fix the washbasin to plaster cardboard walls.

# ACER0730S "CARRARA" Lavabo in marmo bianco di Carrara / Washbasin in white Carrara marble

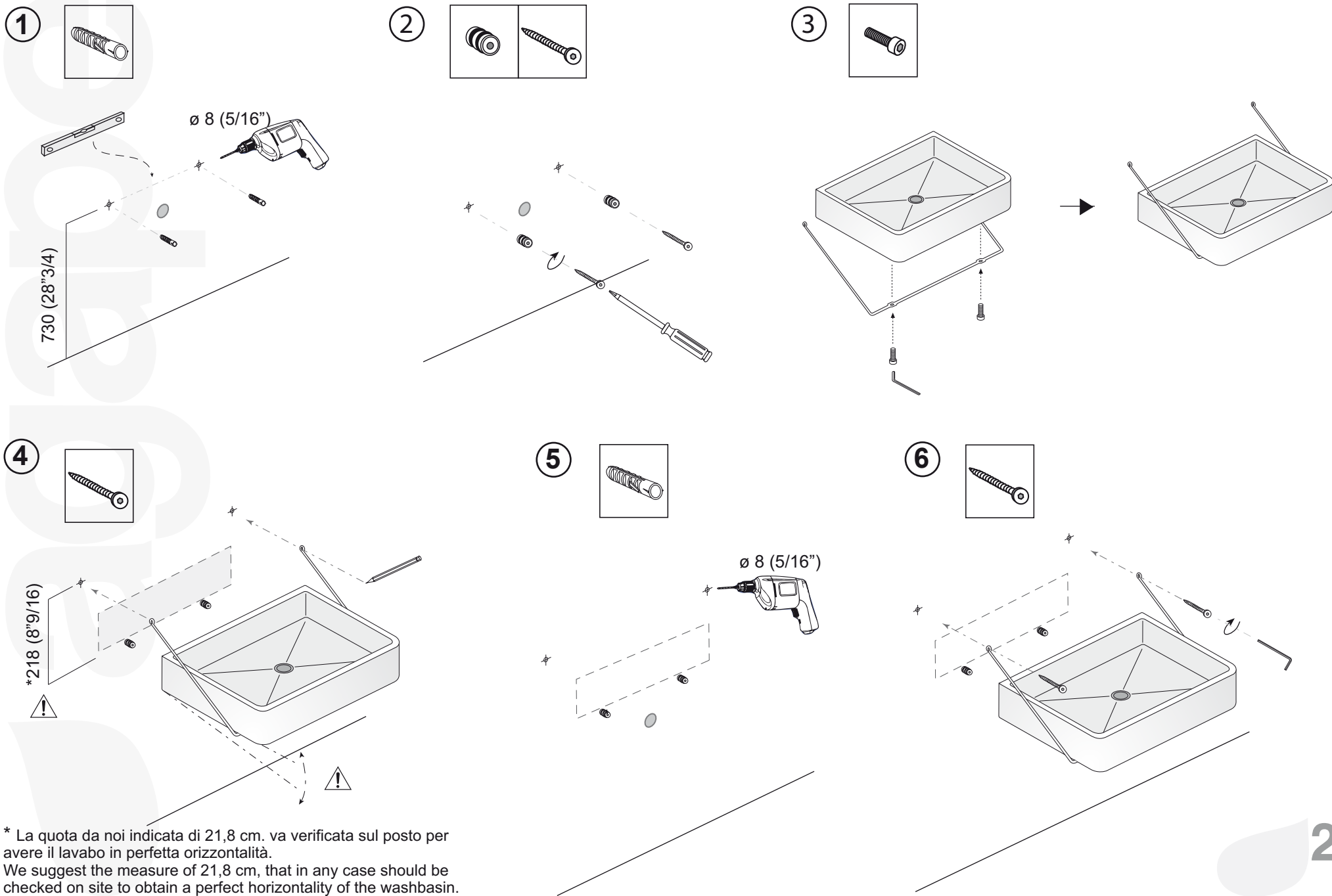

\* La quota da noi indicata di 21,8 cm. va verificata sul posto per avere il lavabo in perfetta orizzontalità.  
 We suggest the measure of 21,8 cm, that in any case should be checked on site to obtain a perfect horizontality of the washbasin.